

## Dimension 200 x 200 to 600 x 600 - Wall fixing - Closed top penstock frame -

Closed top penstock frame

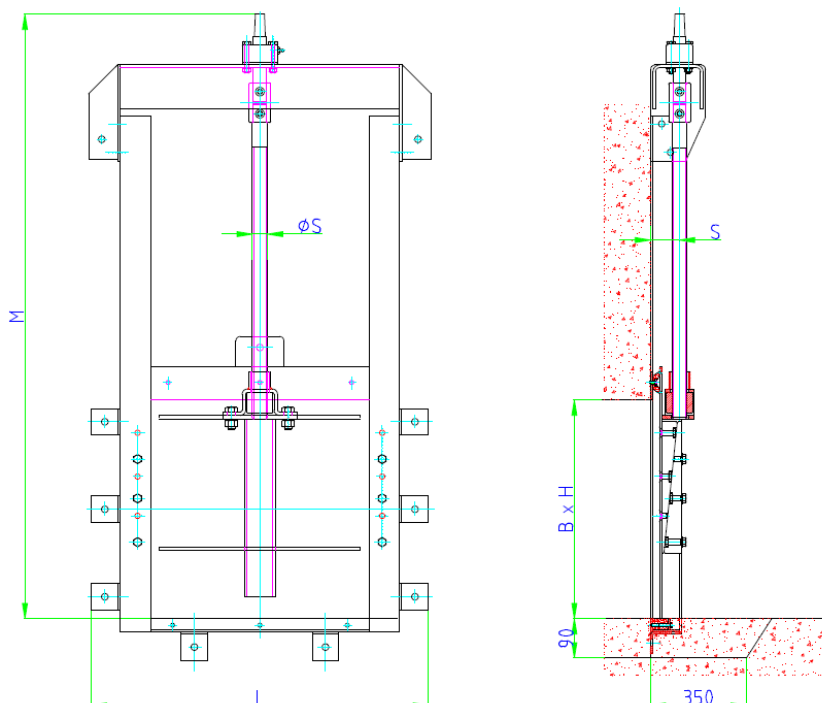

Dimension BxH	L	M	S	ØS	Weight [ kg ]
200 x 200	430	690	50	24	18
300 x 300	570	890	55	30	38
400 x 400	670	1090	55	30	50
500 x 500	770	1330	70	35	66
600 x 600	870	1530	70	35	82

All dimensions in mm

Design: TESACO, acc. to DIN 19569-4, BS 7775:2005, ANSI/AWWA C561-04, 4-face sealing

Material: The following standard material combinations are available:

- Type: A4 - Frame, door and yoke fabricated from S.S. 316
- Type: A2 - Frame, door and yoke fabricated from S.S. 304

Sealing made from waste water resistant rubber neoprene  
 Wedge components made of plastic PA  
 Spindle nut made of zinc-free bronze  
 Spindle made from S.S. 316  
 Fastening elements made from S.S.316

Corrosion protection: Stainless steel pickled and passivated