

Dimension DN 150 to 600 - Pipe flange fixing - Closed top penstock frame -

Closed top penstock frame

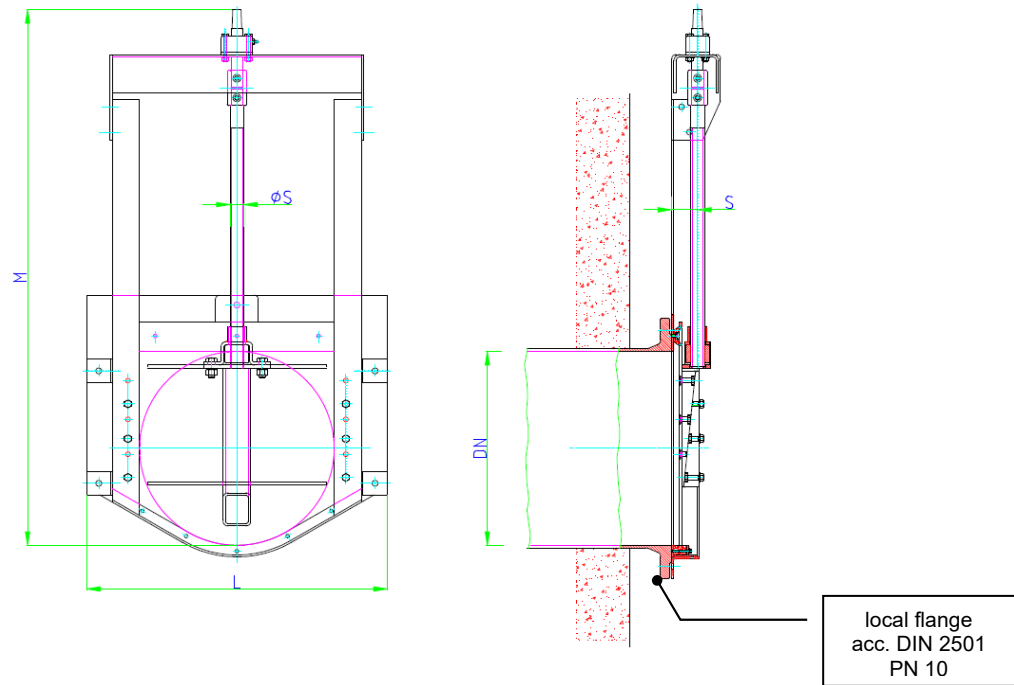

Dimension BxH	L	M	S	ØS	Weight [kg]
DN 150	380	615	50	24	18
DN 200	430	690	50	24	20
DN 250	520	760	55	30	34
DN 300	570	890	55	30	42
DN 350	620	990	55	30	48
DN 400	670	1090	55	30	56
DN 500	770	1330	70	35	74
DN 600	870	1530	70	35	92

All dimensions in mm

Design: TESACO, acc. to DIN 19569-4, BS 7775:2005, ANSI/AWWA C561-04, 4-face sealing

Material: The following standard material combinations are available:

- Type: A4 - Frame, door, yoke and flange plate fabricated from S.S. 316
- Type: A2 - Frame, door, yoke and flange plate fabricated from S.S. 304

- Sealing made from waste water resistant rubber neoprene
- Wedge components made of plastic PA
- Spindle nut made of zinc-free bronze
- Spindle made from S.S. 316
- Flange seal to be provided locally if not individually agreed
- Flange fastening to be provided locally if not individually agreed

Corrosion protection: Stainless steel pickled and passivated