

Dimension 1800 x 1800 to 4000 x 4000

double spindle

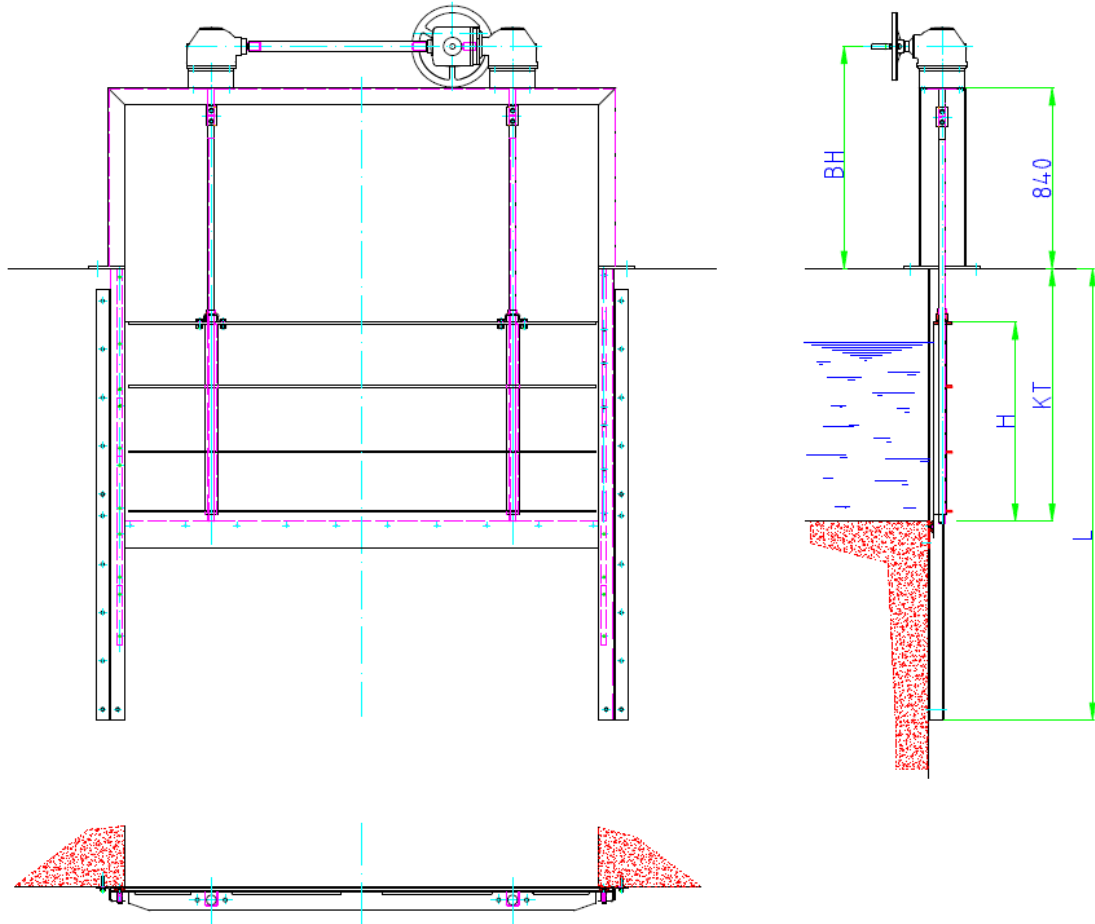

Any special- and intermediate sizes could be delivered!

Design: TESACO, acc. to DIN 19569-4, BS 7775:2005, ANSI/AWWA C561-04, 3-face sealing

Optional: Protective case for rotating, horizontal shaft

Material: The following standard material combinations are available:

Type: A4 - Frame and door fabricated from S.S. 316
 Type: A2 - Frame and door fabricated from S.S. 304

Sealing made from waste water resistant rubber neoprene

Sliding bars made from plastic PE

Spindle nut made of bronze

Spindle made from S.S. 316

Fastening elements made from S.S.316

Corrosion protection: Stainless steel pickled and passivated